

For more information call 020 7060 1475 (UK)
or email enquiries@ polarisworld.info

LOS NARANJOS
de
ALHAMA
GOLF RESORT

From
144,300 €

FRONTLINE GOLF PENTHOUSES PHASE II



The perspectives presented here are an initial conceptual representation of the project and are not definitive project plans. The appearance, design, number and distribution given are only a guide and are subject to modifications due to technical or legal demands.

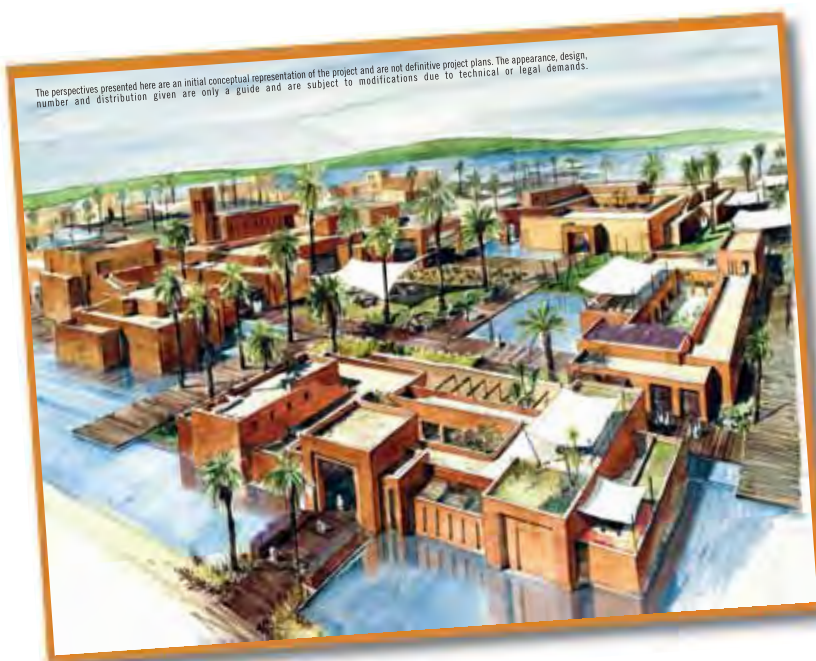

The perspectives presented here are an initial conceptual representation of the project and are not definitive project plans. The appearance, design, number and distribution given are only a guide and are subject to modifications due to technical or legal demands.

Los Naranjos de Alhama is a Resort both named after and represented by the orange tree. This ornamental fruit tree lines the streets and is present in the gardens and squares of the complex, filling them with its sweet fragrance. It is located at the heart of **Condado de Alhama**, a stone's throw from the main Town Centre (Oasis) and next to the central boulevard. As well as access control and a tree-lined avenue which connects it to the rest of the Condado, the Resort has its **own Town Centre**(El Ágora) and the Jack Nicklaus Signature golf course is just opposite.

POLARIS WORLD

No. 1 in Luxury Spanish Properties

For more information call 020 7060 1475 (UK)
or email enquiries@polarisworld.info

LOS NARANJOS
de
ALHAMA
GOLF RESORT



NOTICE: Please bear in mind that the Condado de Alhama set of resorts is a project of great scope which is planned to be executed over several years. However, its other development will be progressive and is being processed in phases. In this respect, we wish to inform you that the Band Bits where The Cortijos de Alhama, Jardines de Alhama, Los Naranjos de Alhama, CI Mirador de Alhama, La Isla del Condado and Golf Suites resorts, the Jack Nicklaus Signature Golf Course associated with them, as well as the Oasis Biscaya complex, ARE LOCATED ON LAND LOTS CLASSIFIED AS DEVELOPABLE LAND ZONED FOR RESIDENTIAL USE IN THE CURRENT ALHAMA DE MURCIA GENERAL URBAN ZONING PLAN. On the other hand, the band bits constituting the site for the two best golf courses and part of the residential kits associated with them, are pending reclassification for zoning purposes so that they can be converted into developable-band bits in accordance with the future general urban zoning plan of the municipality of Alhama de Murcia, which is currently in the preparation phase. In any event, please do not hesitate to contact us for any information on the present and future zoning status of these Band Bits.

Penthouses: the long-awaited phase II

The second phase of Penthouses in Los Naranjos de Alhama Golf Resort is made up of **256 apartments** distributed in 8 four-storey blocks. These Mediterranean-style apartments stand out thanks to the wide open spaces surrounding them and their privileged location opposite the Signature golf course personally designed by Jack Nicklaus.

The new Penthouses have the same stepped architectural design and their terraces provide a lifestyle only penthouses can offer; enjoyment of the outdoors with no impediment from walls or ceilings. Space indoors is used to the full with plenty of light and magnificent views for residents to enjoy.

As opposed to the first phase, the new apartments do not only have views of the immaculately-kept golf course, but also of one of its 5 lakes.

The perspectives presented here are an initial conceptual representation of the project and are not definitive project plans. The appearance, design, number and distribution given are only a guide and are subject to modifications due to technical or legal demands.



The perspectives presented here are an initial conceptual representation of the project and are not definitive project plans. The appearance, design, number and distribution given are only a guide and are subject to modifications due to technical or legal demands.



POLARIS WORLD

No. 1 in Luxury Spanish Properties



PENTHOUSES PHASE II

2 bedroom frontline golf apartments

(1) Built area: up to 67 m² approx.
(2) Terraces: 18 m² approx.
(3) Garden: up to 92 m²

(1) Estimated built areas, counting the 100% of the surface area of the property and 50% of the covered patios. (2) Approximate surface area of terraces, porch, garage and plot, counting the 100%. (3) Approximate surface area of garden, counting the 100%. THIS DOCUMENT IS PROVIDED FOR INFORMATION PURPOSES ONLY. THE DEVELOPER RESERVES THE RIGHT TO MODIFY THE FIGURES BECAUSE OF TECHNICAL OR LEGAL CIRCUMSTANCES.

A world of services for you

Phase II of the Penthouses in Los Naranjos de Alhama enjoys what is perhaps one of the **best locations in Condado de Alhama**, if not the best. As well as having **the exclusive golf course** opposite the properties, it is located at the epicentre of three Town Centres: **El Ágora, Oasis and Foro**.

Being close to the three Town Centres means residents in the new phase of Penthouses will be able to stroll through the gardens and streets of the area to reach the **restaurants, bars, cafés, pubs, gyms, sports centres and shops** of these three centres which are brimming with fine cuisine, leisure facilities, entertainment and life.

